

65101-10227-E

Read the instruction before operating your shade

Installation & Maintenance Instructions Honeycomb Shades Continuous Cordloop & SmartRelease Cordloop

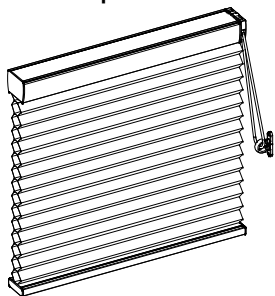

Getting Started

Remove shade from package. Save packaging until shade is installed and working to your satisfaction.

Tools:

- Power drill
- Tape measure
- Screwdriver
- Level
- Pencil



Installation Screws

Surface	Fastener
Wood	Screws (Provided)
Drywall/Plaster	Wall Anchors, Expansion Bolts (Not Provide)
Metal	Sheet Metal Screws (Not Provide)

Check Components / Hardware

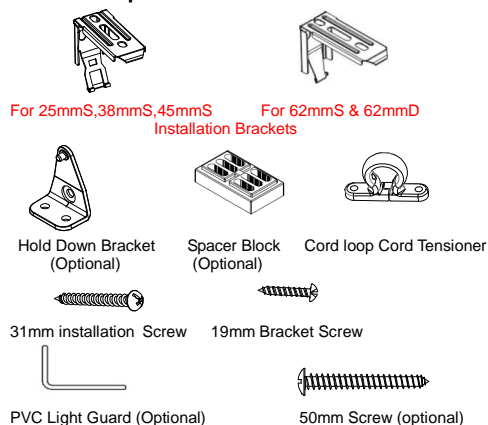

Step 1: Bracket Installation

Measure 75mm from both ends of the head rail. Mark bracket location on the mounting surface.

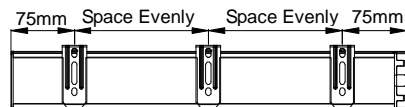

Inside Mount

- For 25mmS, 38mmD, & 45mmS, allocate a minimum distance of 1.8mm from wall to the front of brackets.

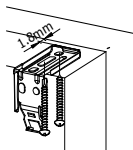

- For 62mm S, 62mm D, align the front of brackets to the edge of window opening as right drawing.

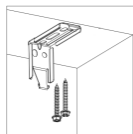

- Use two 31mm installation screws to secure brackets. Use wall anchors for drywall or plaster wall.

Outside Mount

- For 25mmS, 38mmD, & 45mmS, allocate a minimum distance of 16mm from wall to the Bottom of brackets as Right drawing.
- For 62mm S, 62mm D, align the end of brackets with the top window frame as right drawing.

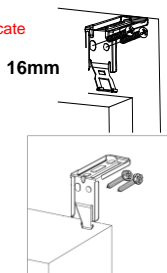

- Use two 31mm screws to attach each bracket. Use wall anchors for drywall or plaster wall.

Note: If spacer block is required for outside mount, please follow the following guide:

Please always make sure the raised side of the spacer block is against the bracket.



If 2pcs spacer blocks are required, please follow the illustration to attach the spacer blocks.



Mount the combination of the bracket and spacer block with two 50mm spacer block screw.

The window frame protrudes from wall by 0-10mm, one spacer block is used.	
The window frame protrudes from wall 10-18mm, two spacer blocks are used.	

Step 2: Shade Installation

- Position head rail at an angle so that it is hooked to the front of the bracket. Then push it upward at the back to snap into the bracket.

⚠ For proper installation, start with attaching the front of the headrail to the bracket.

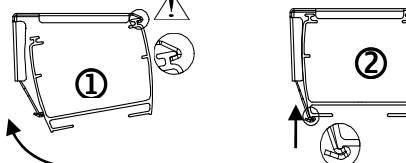

For 25mmS, 38mmD, and 45mmS

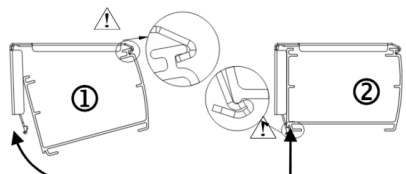

For 62mm S & 62mm D

Step 3: Install Light Guard (Optional for IB)

- The light guard is to be placed at back of the shade at left & right side.

Place the light guard vertically towards the bottom window frame. To avoid scraping, leave a 2mm gap between fabric stack and light guard. And then mark out the location with a pencil.

Remove the double sided tapes and carefully paste the light guard in position.

Note: The light guard on both sides are identical;

Use the double-sided tape on the narrow side of the light guard to attach to the window frame.

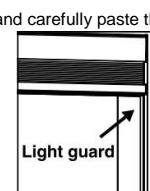

- When light guard length > shade width and ≥ 2000 mm, light guard will be sliced into 2 parts evenly.

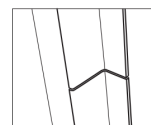

Step 4: Install the Tension device

Children can strangle if this safety device is not installed. Always use this device to keep cords or chains out of the reach of children. Snap the cord into the tension device. Mark the position where the tension device will be installed. The tension device shall be installed at the maximum distance possible from the control mechanism to prevent the looped pull cord(s) becoming slack. Install the tension device with one 19mm screw which must be secured into a solid surface. When positioning and installing the tension device, make sure the chain or cord is taut without stretching, twisting or crossing.

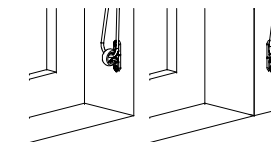

Step 5: Install Hold Down Brackets (optional)

- Use 19mm bracket screw to secure each bracket.

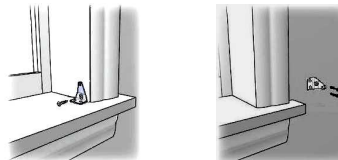

Step 6: Shade Operation

- **For Cordloop,**

- Pull cord to operate shade. Cord bracket must be fully tightened prior to operating the shade.

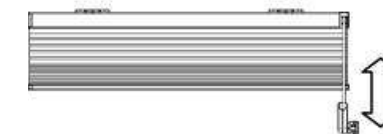

- **For SmartRelease Cordloop**

- Tension Device must be fully tightened prior to operating the shade. Pull the front control cord to let the shade go up.



Pull the back control cord, the shade will go down automatically, till it fully close.

If want to stop the shade go down, only need to pull the front control cord a little.

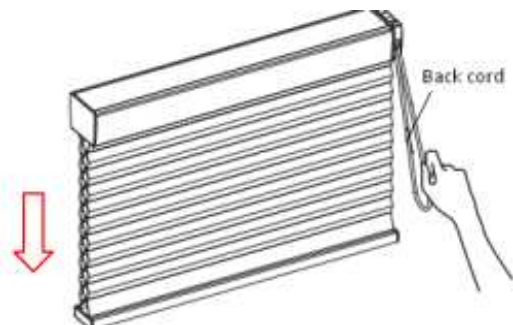

Note: the control cord cannot be too tightened / taut when installing due to its own system character. There should be no obstruction when the shade going down. Please do not play the bottom rail and control cord which may harm the shade.

Remove the Shade

- Fully raise the shade.
- Gently pry the bracket off the head rail with a flat screwdriver.
- Remove the shade.

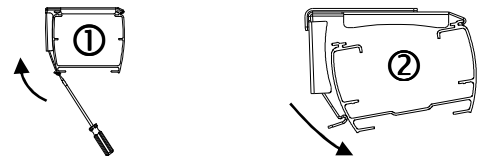

For 25mmS, 38mmD, and 45mmS

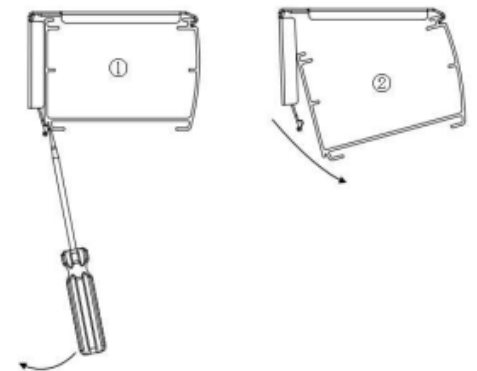

For 62mm S & 62mm D

Note

- Keep away from heat, sparks and open flame.
- Larger windows may require two people to install.
- The shade must be supported firmly during installation to prevent it falling and causing damage to people, property or the blind itself.
- Operate shade only by pulling the cord.
- The cord bracket **MUST** be installed, and tensioned correctly to comply with child safety laws. Please see the child safety instructions included for details.

Cleaning

Routine cleaning will help maintain the beauty of your shade. The shade can be cleaned by using a soft brush, vacuumed with a low suction hand-held vacuum, cleaned ultrasonically (specify that a mild solution must be used and that the head rail should never be immersed in liquid), or dampen a clean cloth with a warm water and mild detergent solution to dab the spot until it's gone (do not rub!)

Warning Label

A warning label is permanently attached to the cord. Do not remove this safety label, even after installation

⚠ WARNING
ALL WINDOW COVERINGS WITH CORD OR CHAIN
To avoid creating a possible strangulation hazard for children, the corded or chained internal window covering must be installed in such a way that a loose cord or chain cannot form a loop 220mm or longer at a height of less than 1600mm above floor level.

- A cord/chain guide may be installed lower than 1600mm above floor level if the cord/chain is sufficiently secured or tensioned to prevent a loop 220mm or longer from being formed.
- If a cord/chain guide is installed lower than 1600mm above floor level, it must be designed to prevent a child from being able to remove the cord/chain.
- If a cleat is used to secure the cord, it must be at least 1600mm above floor level because a child is capable of unwinding a cord from a cleat.